

OWNER: COUNTY LIBRARY
 COUNTY OF GARFIELD
 1000 WEST 10TH AVENUE
 DENVER, CO 80202

ARCHITECT: INTERIOR DESIGN
 1500 WEST 10TH AVENUE
 DENVER, CO 80202

CIVIL ENGINEER
 MATHIAS MARTIN
 1500 WEST 10TH AVENUE
 DENVER, CO 80202

LANDSCAPE ARCHITECT
 ALAN BERMAN COLLABORATIVE
 1500 WEST 10TH AVENUE
 DENVER, CO 80202

STRUCTURAL ENGINEER
 MATHIAS MARTIN
 1500 WEST 10TH AVENUE
 DENVER, CO 80202

MECHANICAL
 DAVE COLLABORATIVE
 1500 WEST 10TH AVENUE
 DENVER, CO 80202

ELECTRICAL, FIRE
 AND LIFE SAFETY
 JOHN C. HENNING
 1500 WEST 10TH AVENUE
 DENVER, CO 80202

HOUSING EXPERT
 JOHN C. HENNING
 1500 WEST 10TH AVENUE
 DENVER, CO 80202

CRESTED BUTTE SOUTH LIBRARY
 LOT 10, BLOCK 6 CRESTED BUTTE
 CO 81224

PROJECT NO. 248
 DATE: 10/20/24
 03/13/2025 PERMIT SET



NO CONSTRUCTION
 TO BE CONSTRUCTED

SNOW STORAGE PLAN
L3.01
 © 2024 INTERIOR DESIGN

AREAS AND REFERENCE NOTE	TOTAL AREA	REQUIRED SNOW STORAGE AREA (20% OF TOTAL AREA)	PROVIDED SNOW STORAGE AREA	SNOW STORAGE LOCATION
PARKING LOT (SEE NOTE 1)	10,780 SF	3,560 SF	8,970 SF	SEE NOTE 1
PERESTRAN VERGELATION (CONCRETE SUBGRAVUS AND TREES)	7,300 SF	2,440 SF	4,190 SF	SEE NOTE 1
CRIBBERIES PAVING	1,800 SF	560 SF	600 SF	SEE NOTE 1

REFERENCE NOTE:
 1 SNOW STORAGE TO BE BELOW 30" HEIGHT WITHIN SIGHT DISTANCE TRIANGLES.

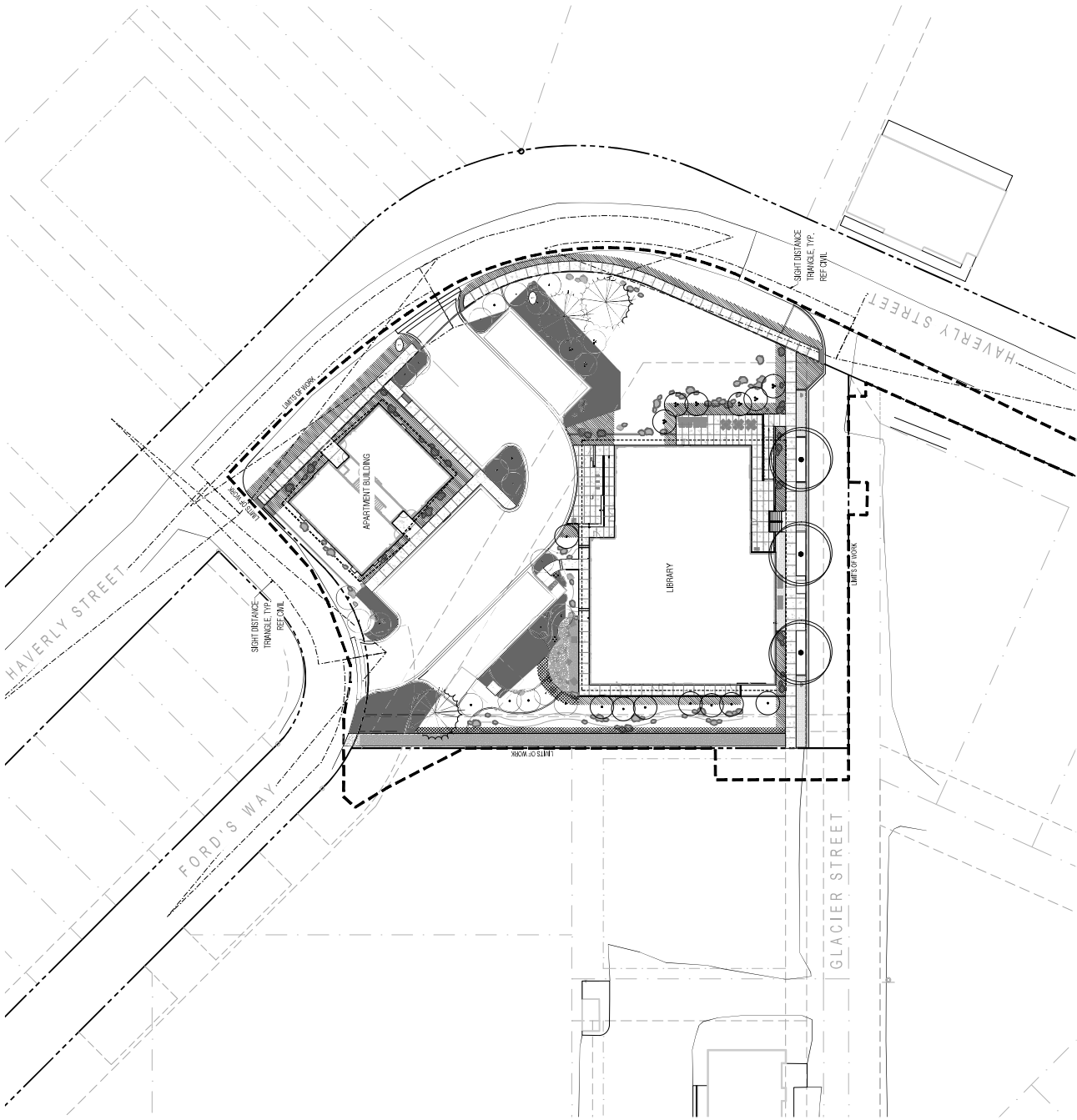

1 SNOW STORAGE PLAN
 1" = 20'-0"